

# EAST 66<sup>TH</sup> STREET IMPLEMENTATION PLAN

**STAKEHOLDER MEETING – 06.24.2020**

MidTown Cleveland  
Northeast Ohio Areawide Coordinating Agency  
City of Cleveland  
Twelve Literary Arts  
Lattimore Productions  
City Architecture

WELCOME  
&  
CHECK-IN





# **NEIGHBORHOOD UPDATES**

- **COMMUNITY  
CONVERSATIONS**
- **RESIDENT SURVEYS**
- **RESIDENT MEETINGS  
– June 26 & July 24**
- **YOUTH ADVISORY  
BOARD**
- **OTHER?**

Zoom Meeting Participant ID: 347575

Lexy Lattimore is sharing computer sound

Kaykay's iPhone is talking...

Participants (36)

Find a participant

- JC Juleian Curtis (Me, participant ID: 347575)
- Michelle Bandy-Zalatoris (Host)
- LL Lexy Lattimore
- Krysta Pesarchick (Co-host)
- Alex Pesta
- BC Beverly C Williams
- BL Brittany Lee

Zoom Group Chat

From Dion Hardy to Everyone: Hi

From Joyce Huang to Everyone: ohhhh  
Hi Dion, Kaykay, jamal

From Lexy Lattimore to Everyone: Hahah - thanks, Daniel! :)

From Daniel Gray-Kontar to Everyone: Much love to the youth in the space!

From Alex Pesta to Everyone: great choice with Gambinol!

From Joyce Huang to Everyone: appropriate

From Brittany Lee to Everyone: <3 <3 <3 <3

To: Michelle Bandy-Zalatoris (Privately)

Type message here...

# Kitchen Table Conversation – Community Meeting

A MEET-UP TO DISCUSS REDESIGNING E. 66TH STREET

Friday, June 5  
5:30-7:00PM

**KITCHEN TABLE CONVERSATIONS**

Zoom ID: 853 3141 5387  
Password: E66Street3  
Dial-In: (301) 715-8592  
Web: <http://tiny.cc/E66-kitchen>

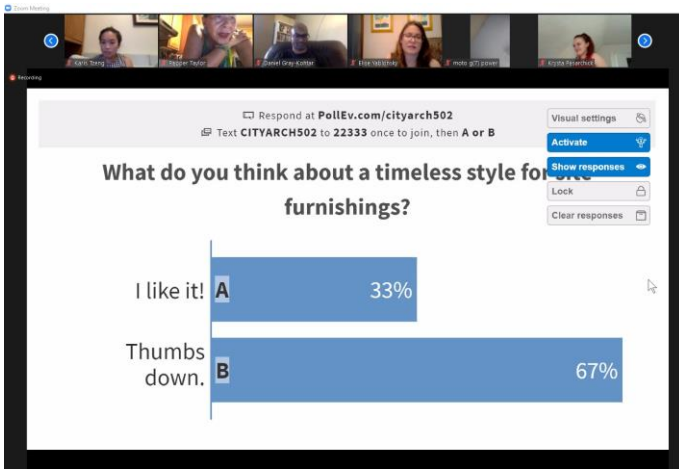

RESIDENTS ALONG E66TH STREET

How Could Your Experience Be Improved?

- More lights
- More cameras
- Keeping things clean
- Bike trail

"There's one area that's more secluded closer to the Euclid part of E66. That's where they have some factories and Dunham Tavern. When you're walking from Euclid that area is a bit more secluded until you get to Chester. Our street is unique because it has some high traffic times like when there's an event, but for the most part its quiet"

"We don't really walk down past Linwood, we walk where league park is."

CLEVELAND FOUNDATION

WE HAVE A DREAM FOR HOUGH!

An update to the 2012 League Park TLCJ Plan  
Northeast Ohio Area-wide Coordinating Agency  
Public Meeting Vol. 2

# Youth Design Session



# Youth Design Session

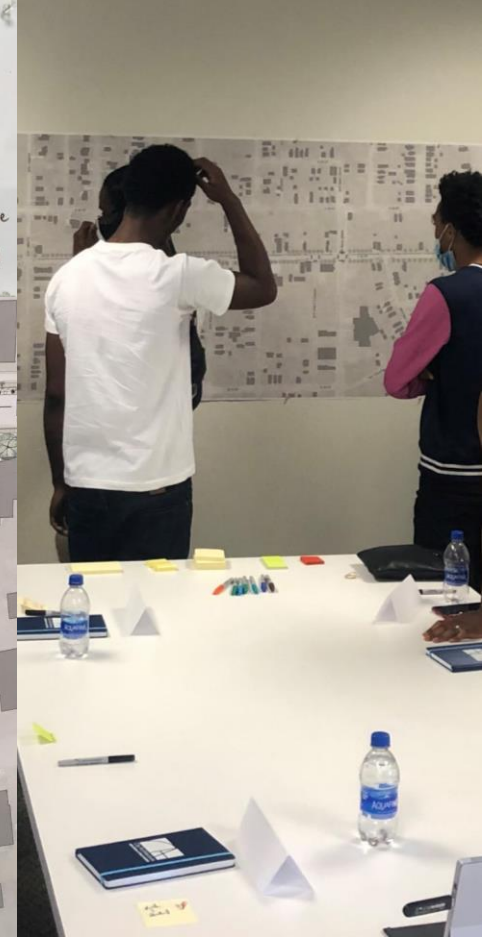
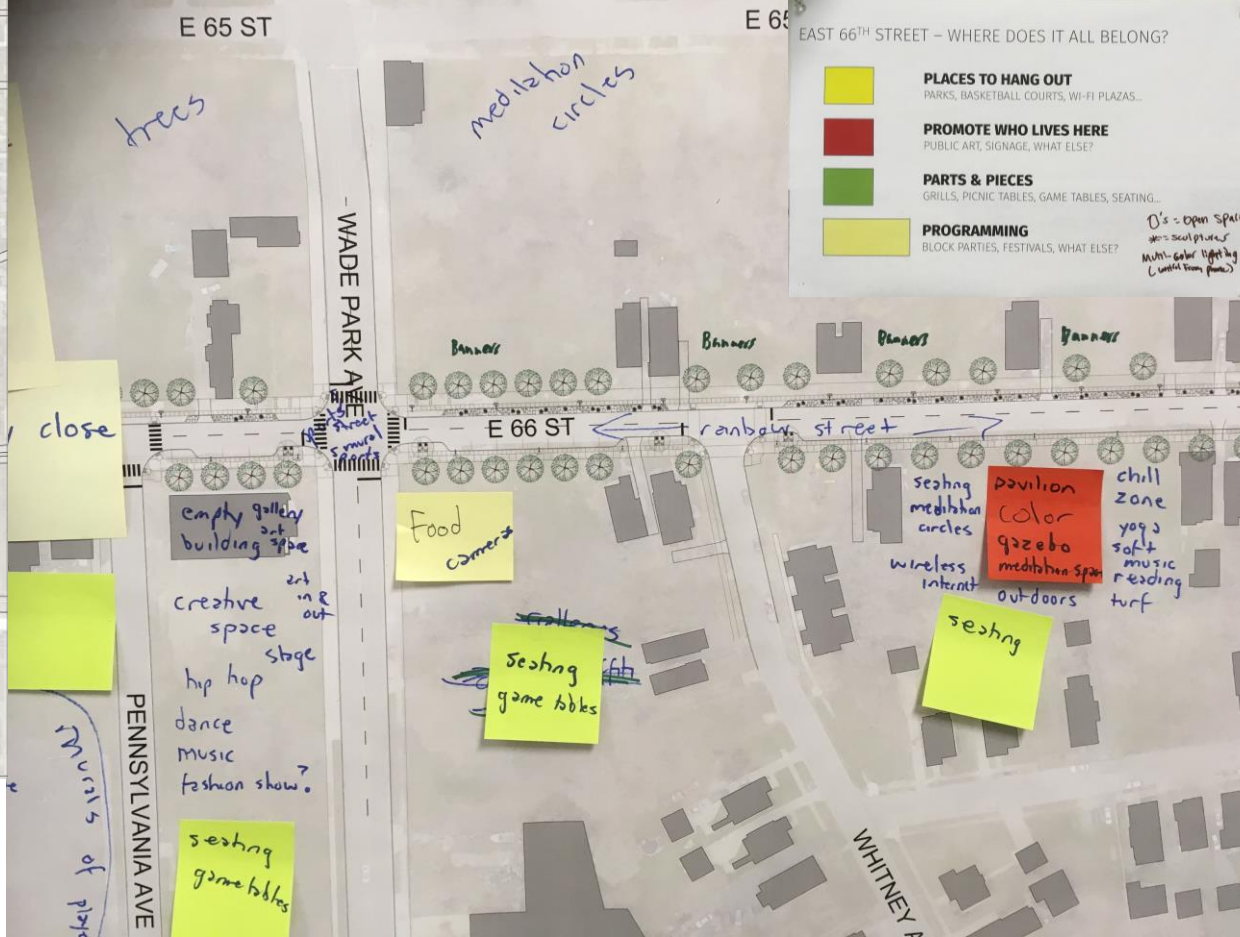
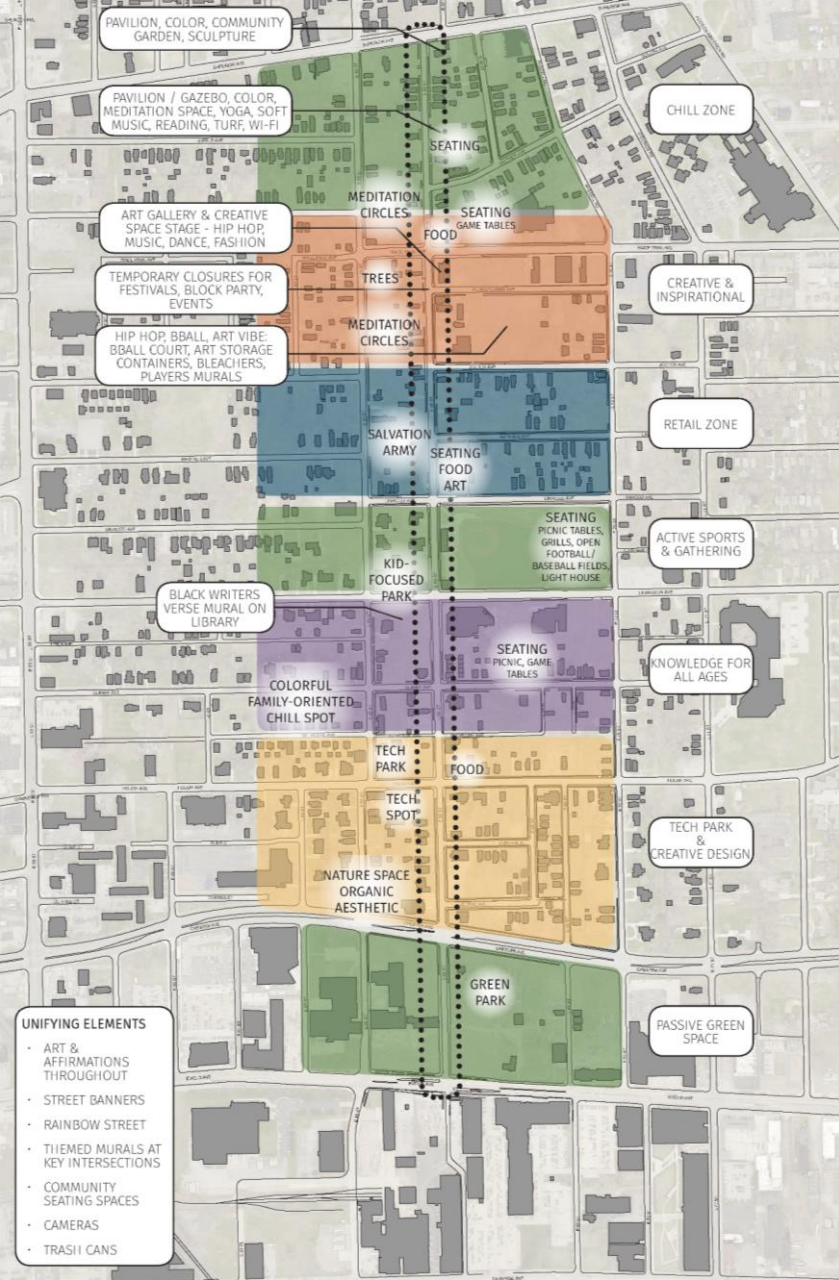

Youth Design Session  
Vision Map

# EAST 66<sup>TH</sup> STREET EXISTING ROADWAY LAYOUT

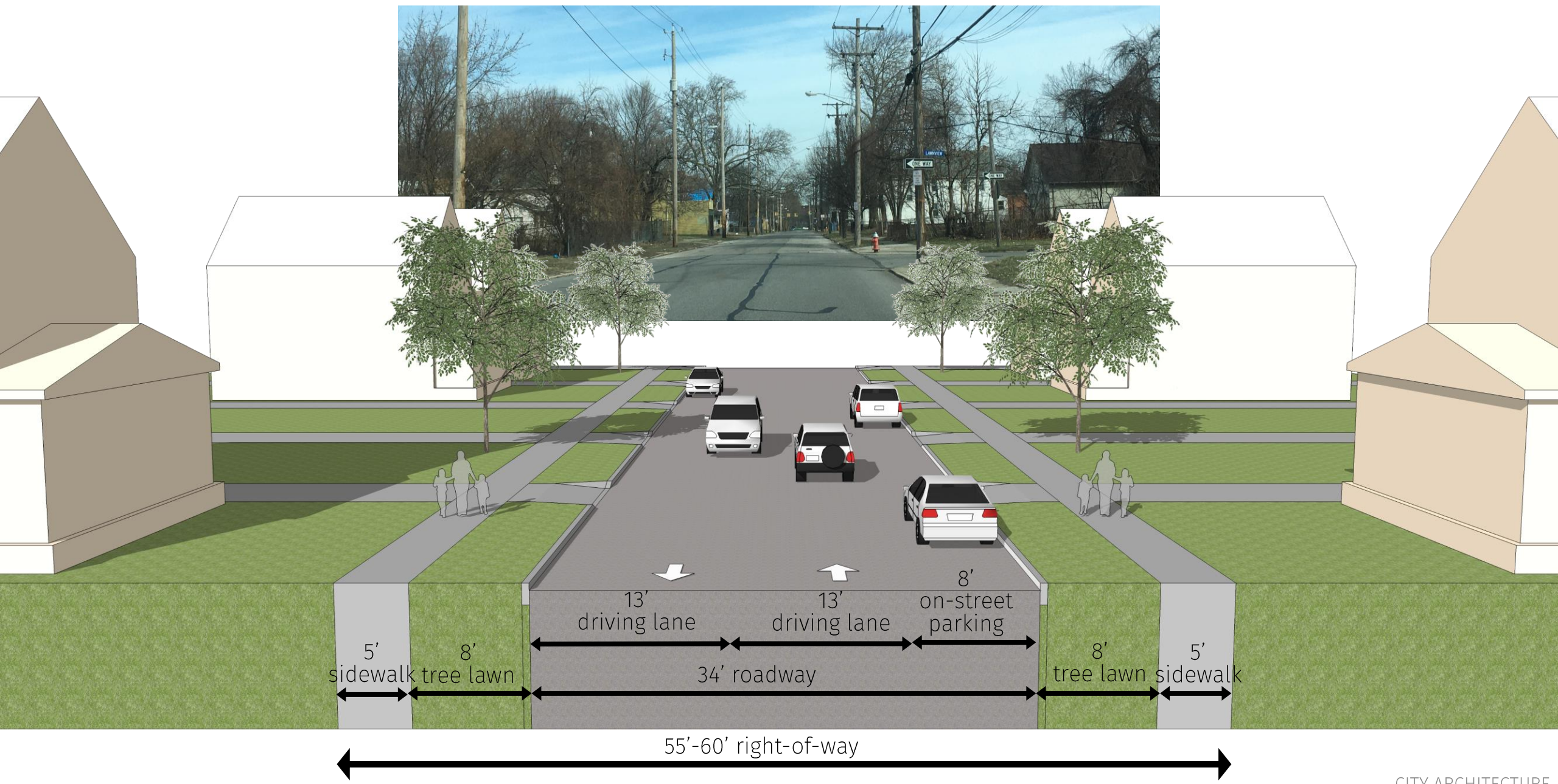

# EAST 66<sup>TH</sup> STREET ROADWAY CONCEPT 6

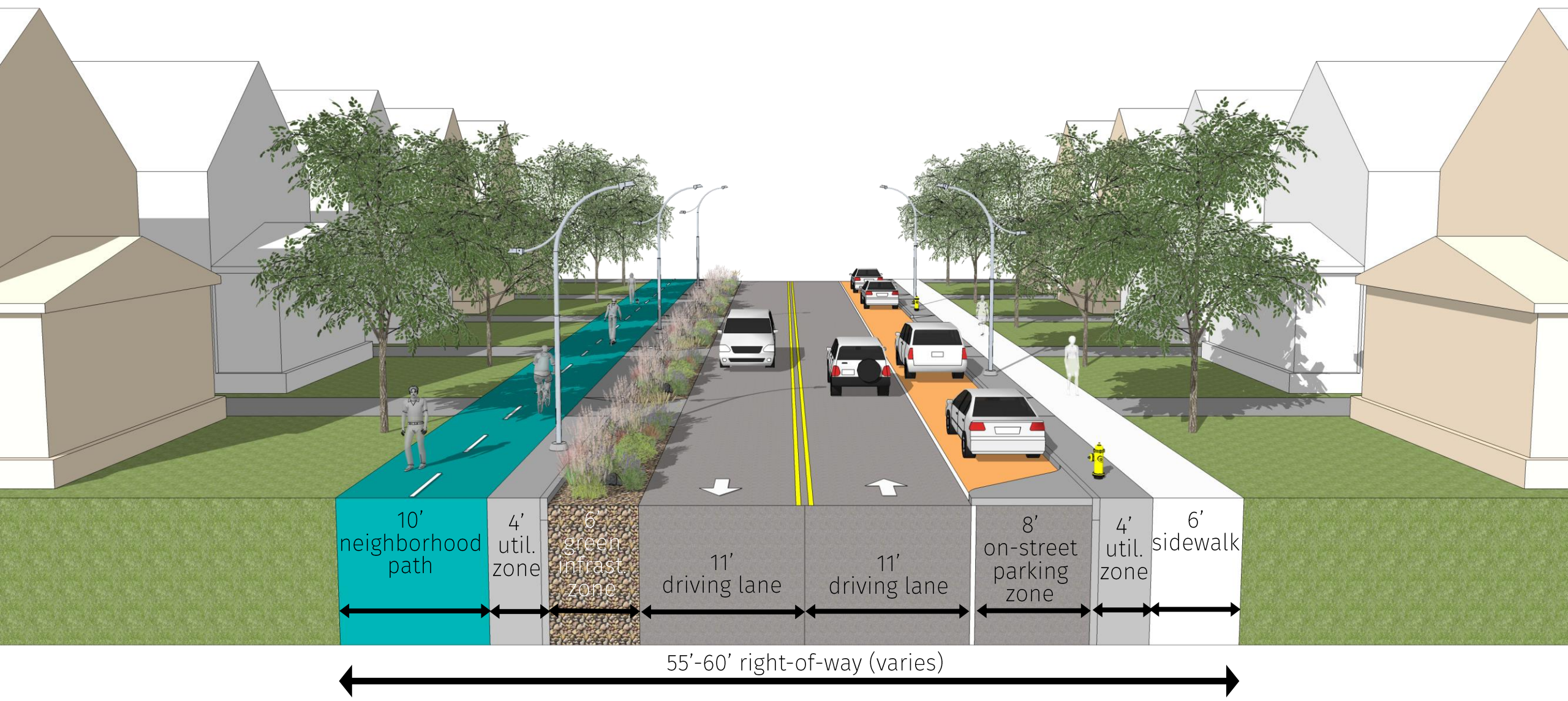



# YOU SAID

“Any light you can put on our street is good! There are lots of pockets of darkness.”

“I definitely want to have some more trees.”

“We need a bike lane and places to park our bikes.”

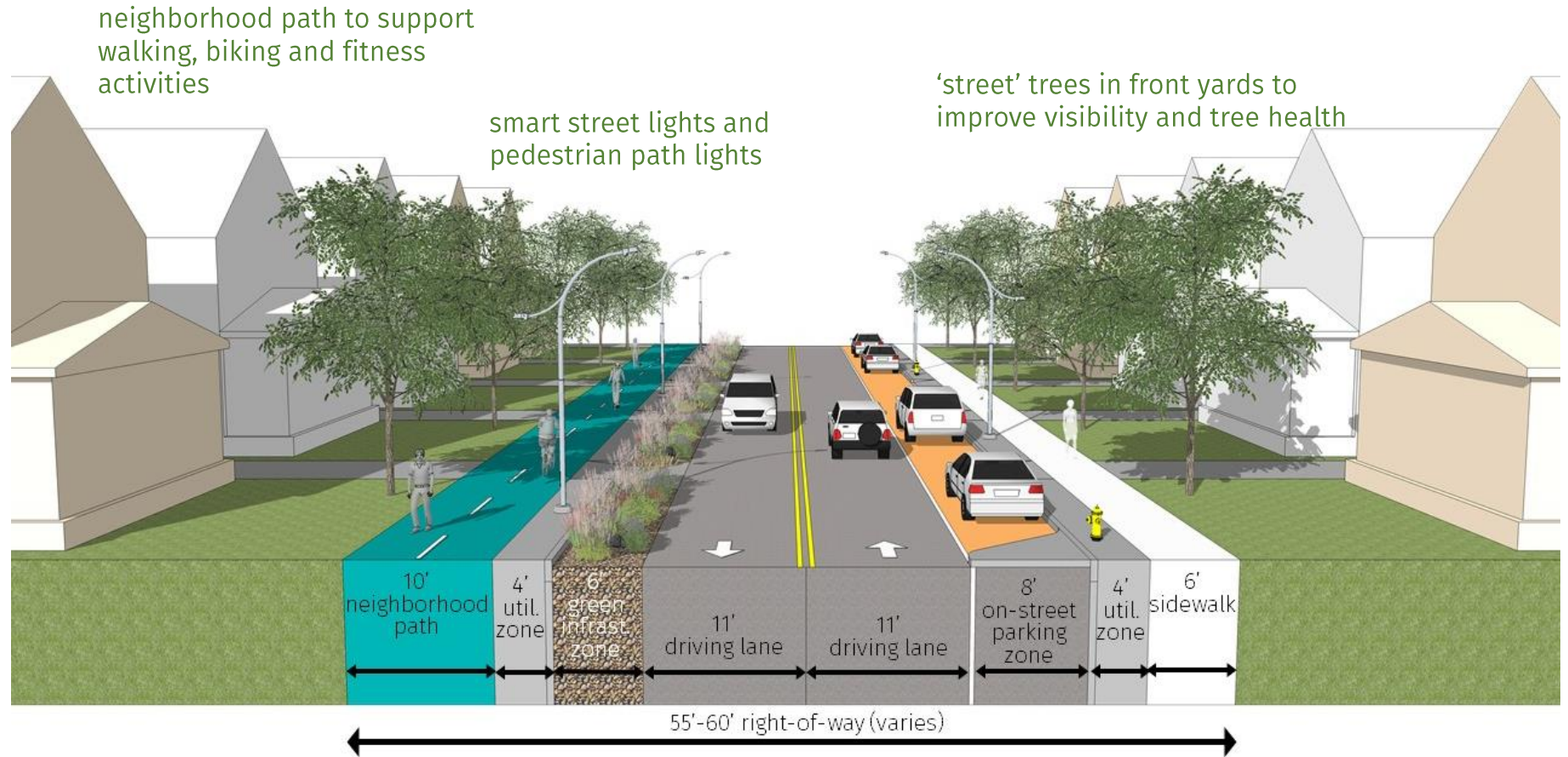

# YOU SAID

“(We need) a very walkable street - a place people will be inspired not to drive”

“More intentional connection between MidTown Tech Hive and the neighborhood”

“I think it’d be really nice for safety to have a hearing accessible crossing”

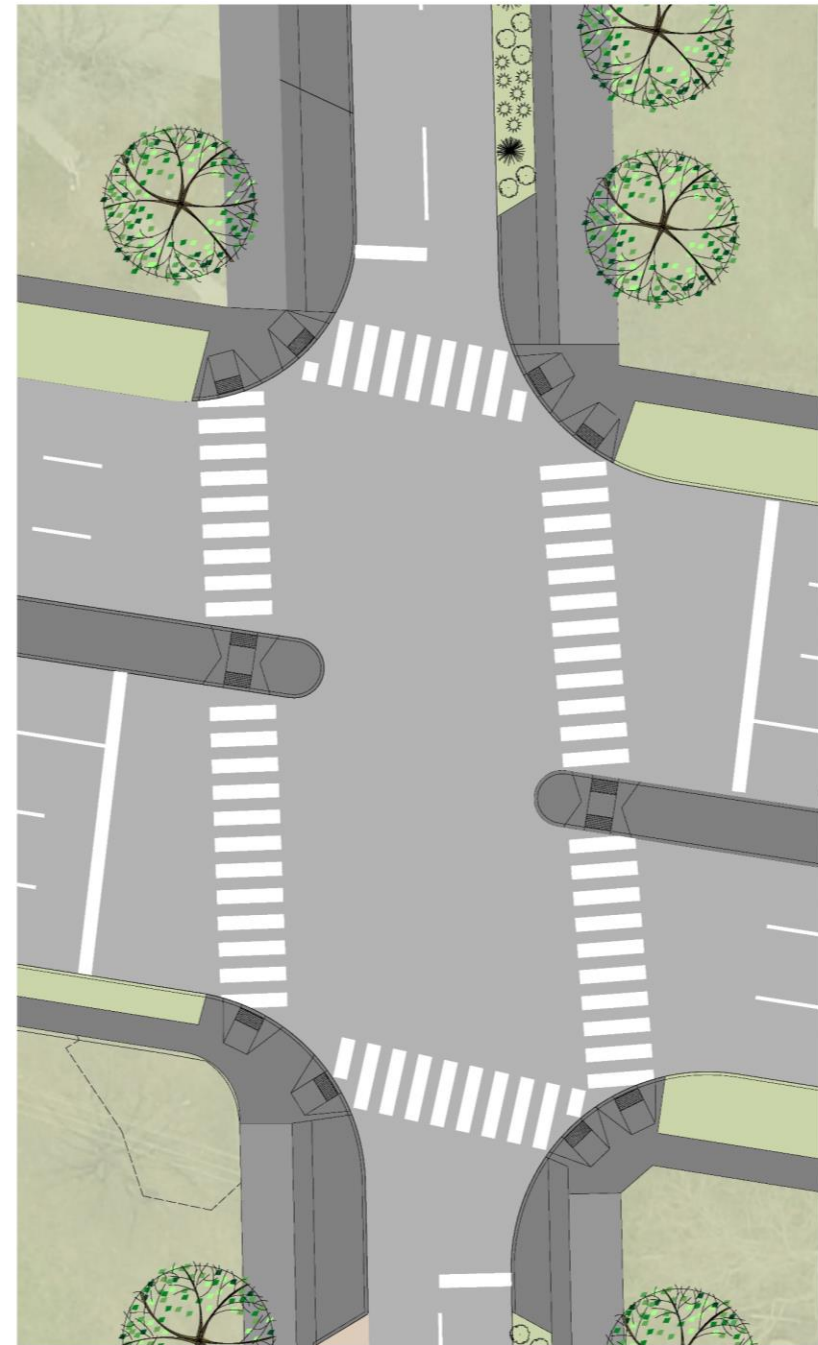

Narrowed turning lanes to widen median as pedestrian refuge space

Medians extended into intersection to receive crosswalks

15'-20' wide crosswalks to emphasize pedestrian and bicycle paths of movement

Pedestrian activated crosswalk signals, with audible and visual signals

# YOU SAID

“Affirmations. Yeah. And a lot of colors.”

“The street should be a safe zone similar to the “Safe Zone Sundays” idea at Kerusch Park.”

“To make it safer if we build Hough the same way they got E. 4th where they got all them bars at so you can't even drive a car through there - you know what I mean?”



Street layout and details to support closures for neighborhood events – accessible power, water, gateways, etc.

Special paving in parking lane and in specific blocks to support festive atmosphere for closing street

Seating and coverings for gathering spaces

EAST 66<sup>TH</sup>  
STREET  
TLCI

CLEVELAND, OHIO

EAST 66TH AT  
EUCLID AVE

049

11806049

11806027

11806026

1180

1180

528

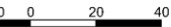
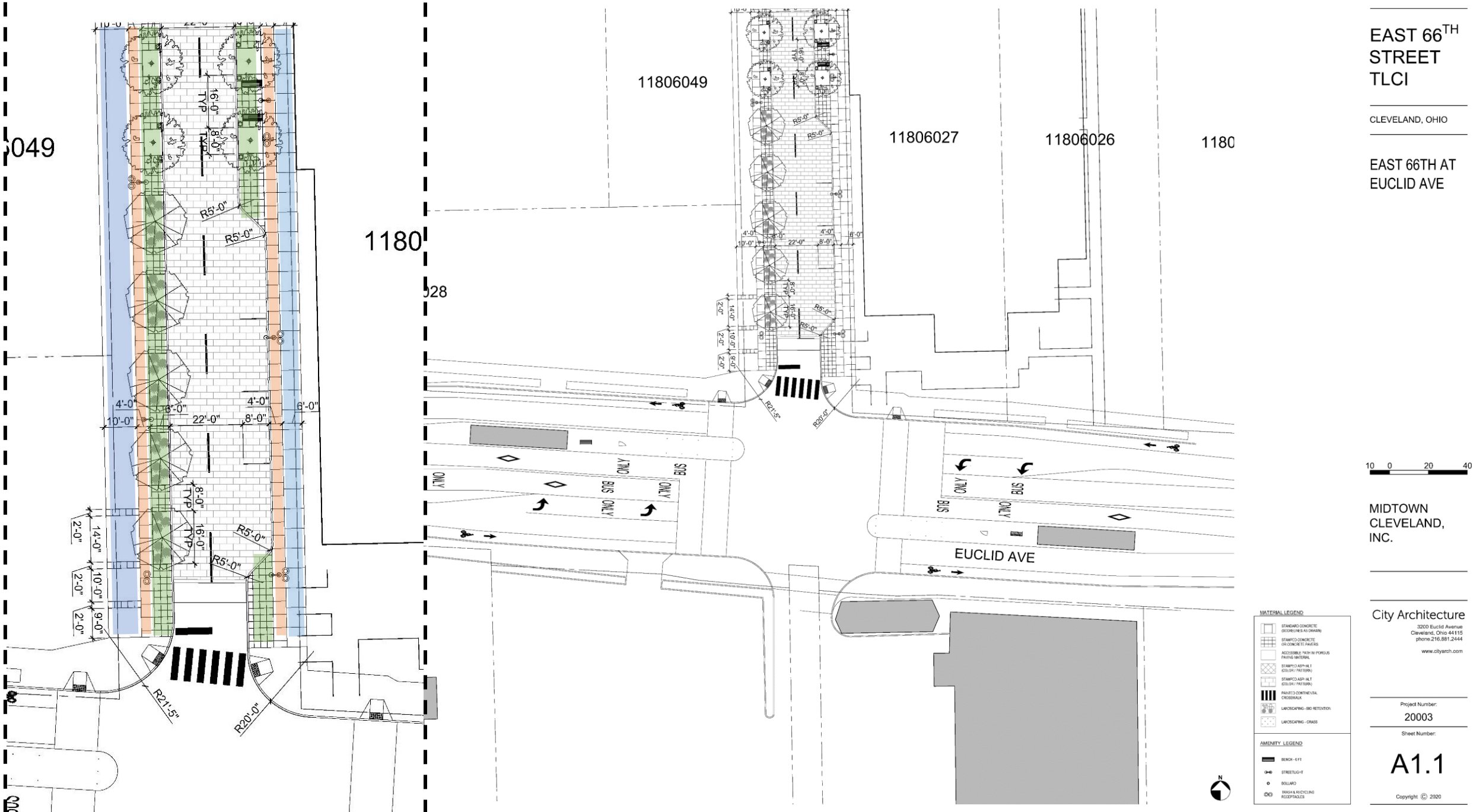

MIDTOWN  
CLEVELAND,  
INC.

City Architecture

3200 Euclid Avenue  
Cleveland, Ohio 44115  
phone 216.881.2444  
www.cityarch.com

Project Number:

20003

Sheet Number:

A1.1

Copyright © 2020

MATERIAL LEGEND

- STANDARD CONCRETE (SEE NOTES AS APPLICABLE)
- STAMPED CONCRETE (SEE NOTES AS APPLICABLE)
- ACCESSIBLE PAVEMENT (PERVIOUS PAVING MATERIAL)
- STAMPED ASPHALT (COLOR: PATTERN)
- STAMPED ASPHALT (COLOR: PATTERN)
- PAINTED CONCRETE (COLOR: PATTERN)
- LANDSCAPING - 80% RETENTION
- LANDSCAPING - 0% RETENTION

AMENITY LEGEND

- BENCH - EFF
- STREETLIGHT
- BALLARD
- TRASH & RECYCLING RECEPTACLES



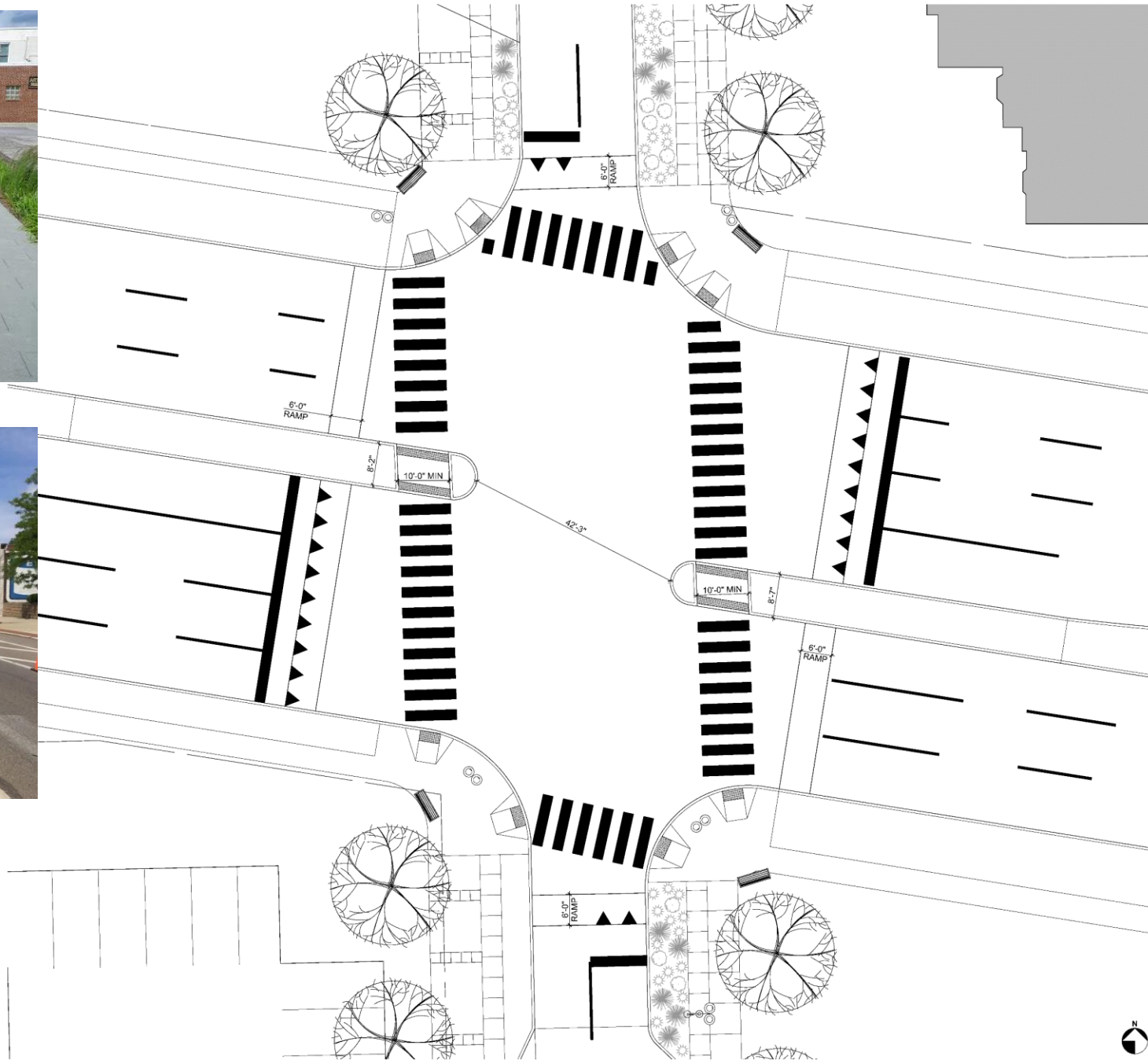

**EAST 66<sup>TH</sup>  
STREET  
TLCI**

CLEVELAND, OHIO

**EAST 66TH AT  
CHESTER AVE -  
ENLARGED  
PLAN**

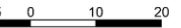

MIDTOWN  
CLEVELAND,  
INC.

City Architecture

3200 Euclid Avenue  
Cleveland, Ohio 44115  
phone 216.881.2444  
www.cityarch.com

Project Number:

**20003**

Sheet Number:

**A1.3A**

Copyright © 2020

**MATERIAL LEGEND**

- STANDARD CONCRETE (SQUARES AS SHOWN)
- STAMPED CONCRETE (DIAGONALS AS SHOWN)
- ACCESSIBLE PAW IN PAVEMENT (DIAGONALS AS SHOWN)
- STAMPED ASPHALT (DIAGONALS AS SHOWN)
- PAINTED CONCRETE (DIAGONALS AS SHOWN)
- LANDSCAPING - 80% RETENTION
- LANDSCAPING - GRASS

**AMENITY LEGEND**

- BENCH - EFF
- STREETLID - F
- BOLLARD
- BRUSH & RECYCLING RECEPTACLES

X:\2020\20003 - East 66th Street - Development Concept\30-31-Highway\Highway\Site Files\enlarged.dwg, 10/17/20

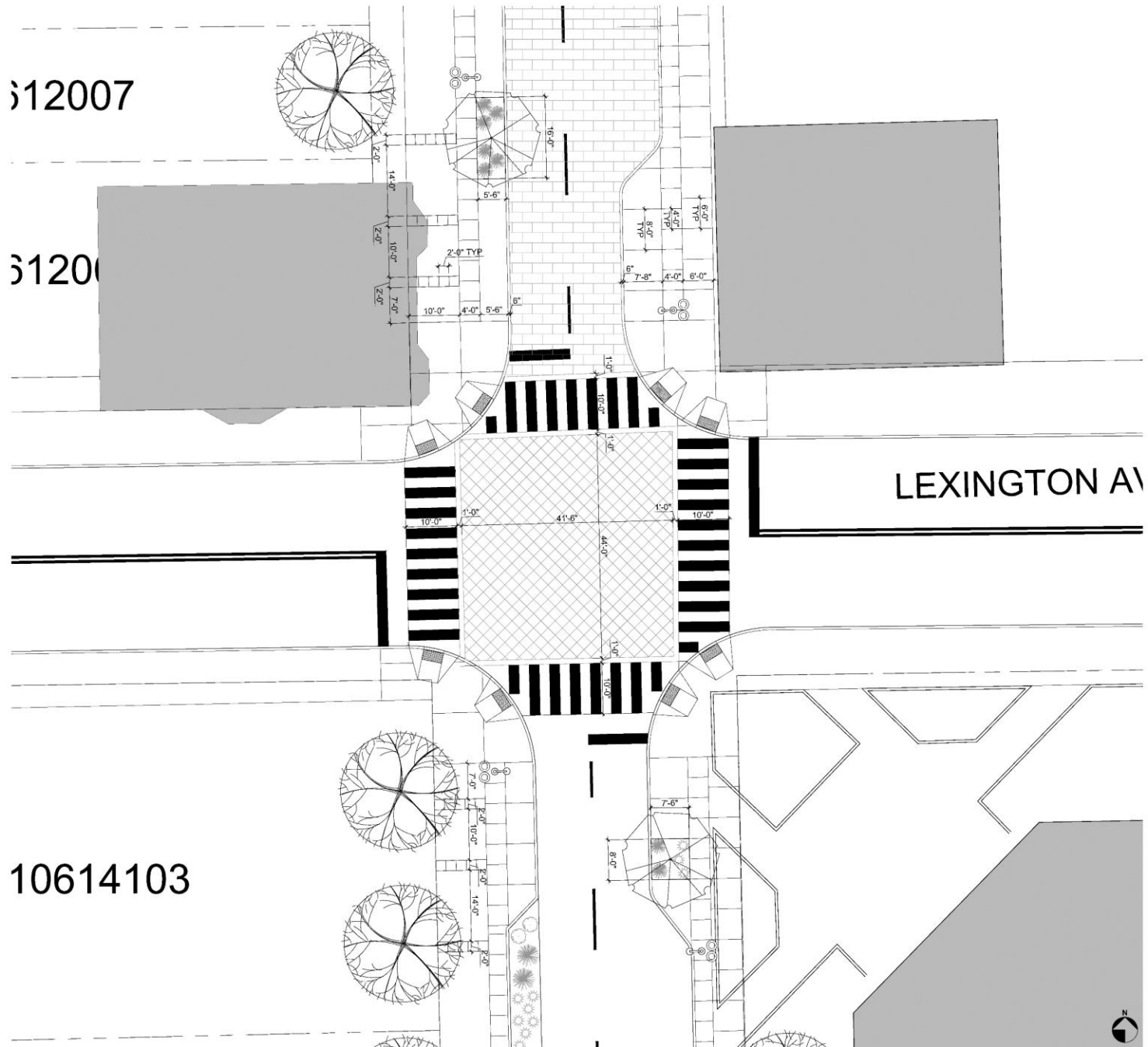

**EAST 66<sup>TH</sup>  
STREET  
TLCI**

CLEVELAND, OHIO

**EAST 66TH AT  
LEXINGTON AVE  
- ENLARGED  
PLAN**

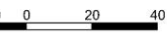

MIDTOWN  
CLEVELAND,  
INC.

City Architecture  
3200 Euclid Avenue  
Cleveland, Ohio 44115  
phone 216.881.2444  
www.cityarch.com

Project Number:  
**20003**

Sheet Number:

**A1.7A**

Copyright © 2020

MATERIAL LEGEND	
	STANDARD CONCRETE (COLORS AS SHOWN)
	STAMPED CONCRETE (OR CONCRETE FINISH)
	ACCESSIBLE 15'x30' POROUS PAVING MATERIAL
	STAMPED ASPHALT (COLORS AS SHOWN)
	PAINTED CONCRETE (COLORS AS SHOWN)
	LANDSCAPING - 60" RETENTION
	LANDSCAPING - CRACKS

AMENITY LEGEND	
	BENCH - 4'x1'
	STREET LIGHT
	BOLLARD
	TRASH & RECYCLING RECEPTACLES

X:\2020\20003 - East 66th Street - Streetscape Concept\20 - Planning\Mapsets\01 - Site Plan - Proposed.dwg, 10/17/2020, 1:42:28 PM

**EAST 66<sup>TH</sup> STREET TLCI**

CLEVELAND, OHIO

EAST 66TH NORTH OF LEXINGTON AVE

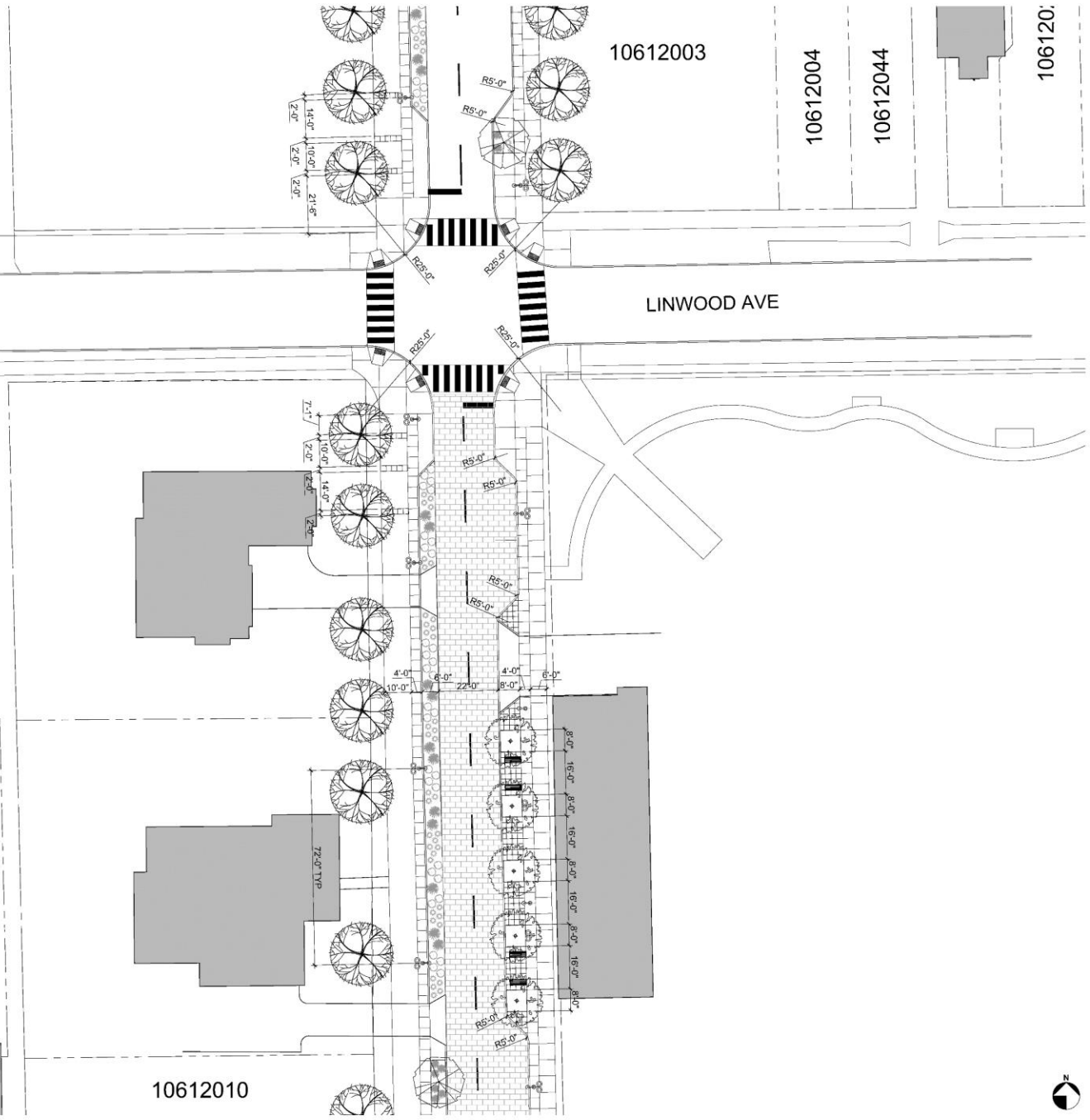
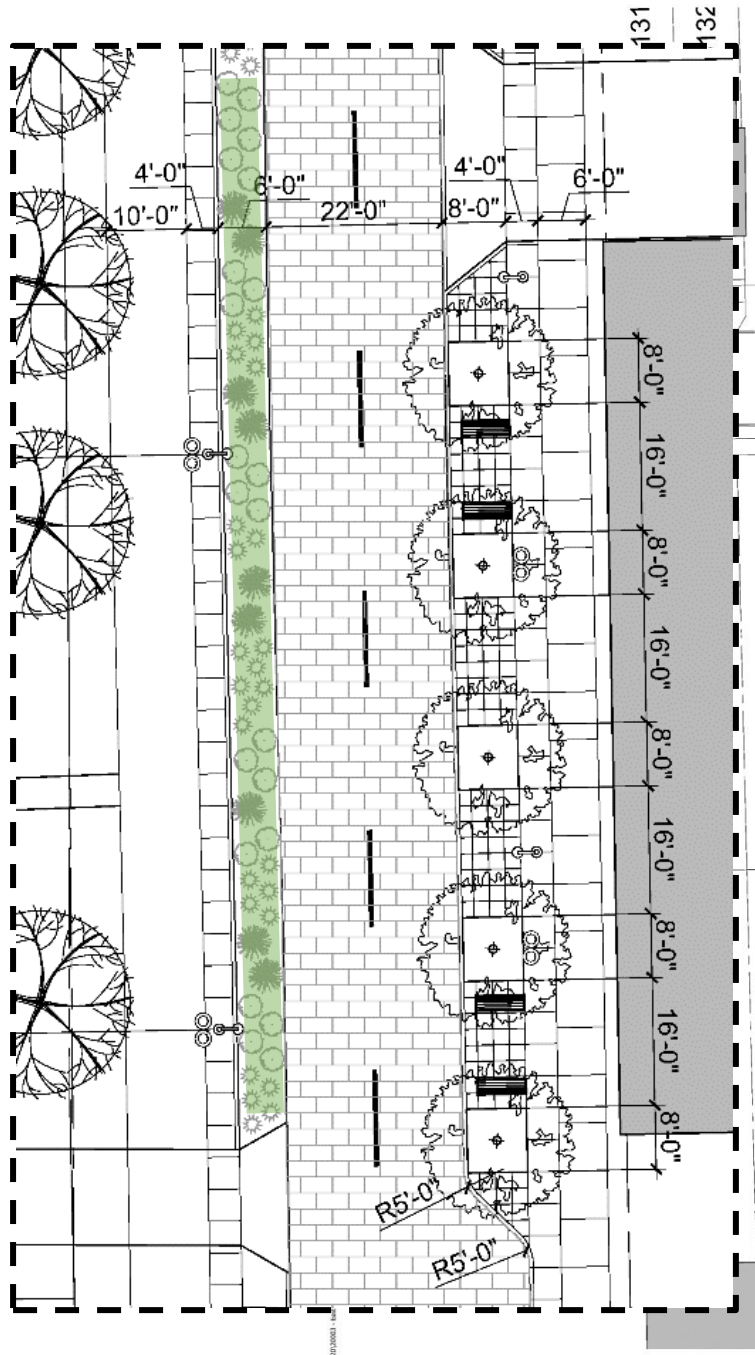

10612003

10612004

10612044

106120:

LINWOOD AVE

10612010

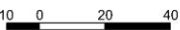

MIDTOWN CLEVELAND, INC.

City Architecture

3200 Euclid Avenue  
Cleveland, Ohio 44115  
phone 216.881.2444  
www.cityarch.com

Project Number:

20003

Sheet Number:

**A1.8**

Copyright © 2020

MATERIAL LEGEND	
	STANDARD CONCRETE (COLOR: PINE-SIL DRUM)
	STAMP CONCRETE (COLOR: PINE-SIL DRUM)
	ACCESSIBLE PAVEMENT (POROUS PAVING MATERIAL)
	STAMP ASPHALT (COLOR: PISTACHIO)
	PAINTED CONCRETE (COLOR: PISTACHIO)
	LANDSCAPING - 80% RETENTION
	LANDSCAPING - GRASS

AMENITY LEGEND	
	BENCH - 4 FT
	STREETLIGHT
	BOLLARD
	TRASH & RECYCLING RECEPTACLES

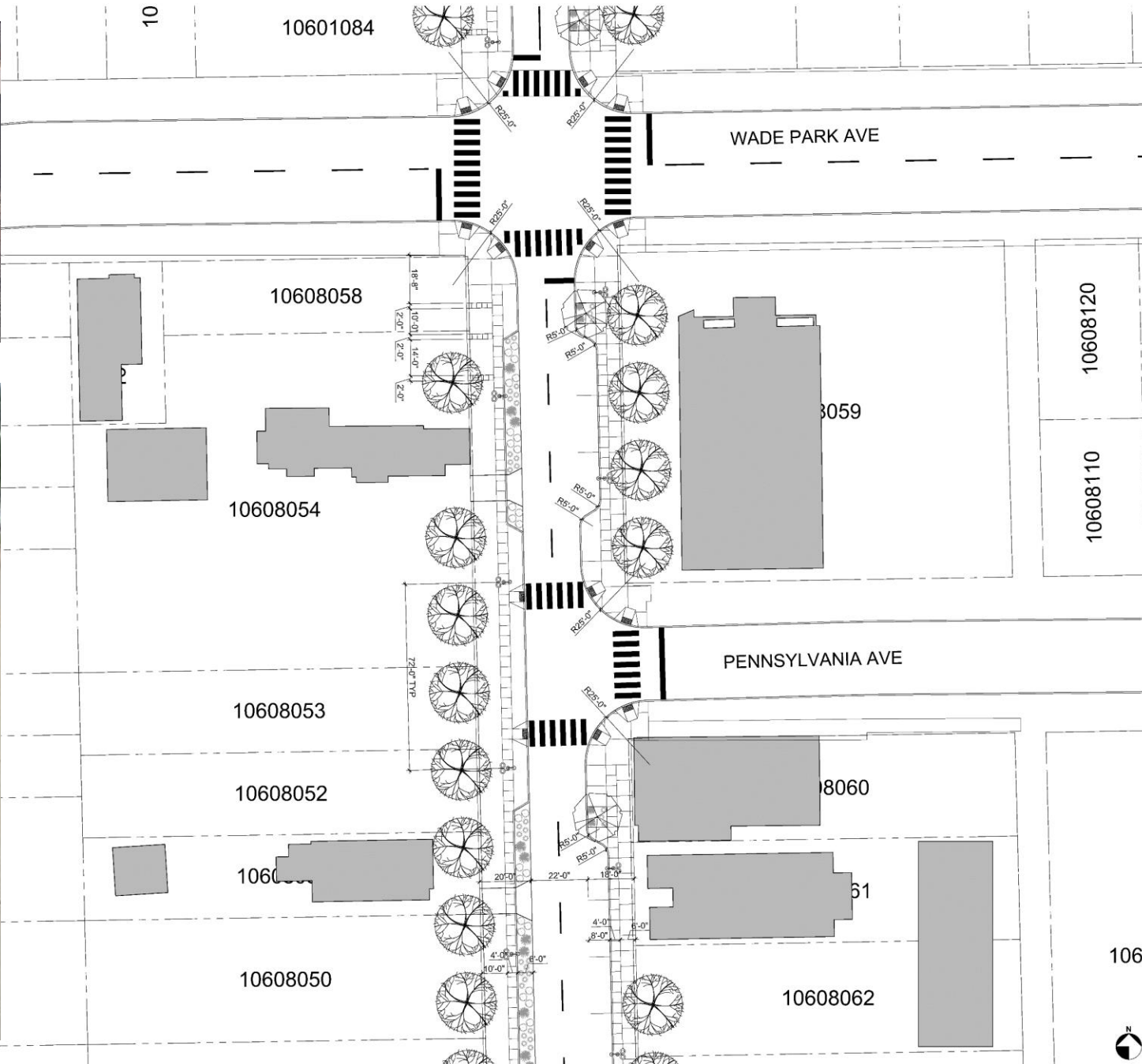

**EAST 66<sup>TH</sup> STREET  
TLCI**

CLEVELAND, OHIO

EAST 66<sup>TH</sup> AT  
WADE PARK AVE

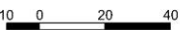

MIDTOWN  
CLEVELAND,  
INC.

City Architecture  
3200 Euclid Avenue  
Cleveland, Ohio 44115  
phone 216.881.2444  
www.cityarch.com

Project Number:  
**20003**  
Sheet Number:

**A1.11**

Copyright © 2020

MATERIAL LEGEND	
[Symbol]	STANDARD CONCRETE (COLORS AS SHOWN)
[Symbol]	STAMPED CONCRETE (COLORS AS SHOWN)
[Symbol]	ACCESSIBLE PAVEMENT POROUS PAVING MATERIAL
[Symbol]	STAMPED ASPHALT (COLOR / PATTERN)
[Symbol]	STAMPED ASPHALT (COLOR / PATTERN)
[Symbol]	PAINTED CONCRETE / CURBLINE
[Symbol]	LANDSCAPING - B&B RETENTION
[Symbol]	LANDSCAPING - GRASS
AMENITY LEGEND	
[Symbol]	BENCH - EFF
[Symbol]	STREETLUG - F
[Symbol]	BOLLARD
[Symbol]	BRUSH & RECYCLING RECEPTACLES

X:\2020\20003



design elements -  
overall style- traditional



design elements -  
overall style - timeless



# WHAT DOES IT LOOK LIKE?

design elements -  
overall style - modern

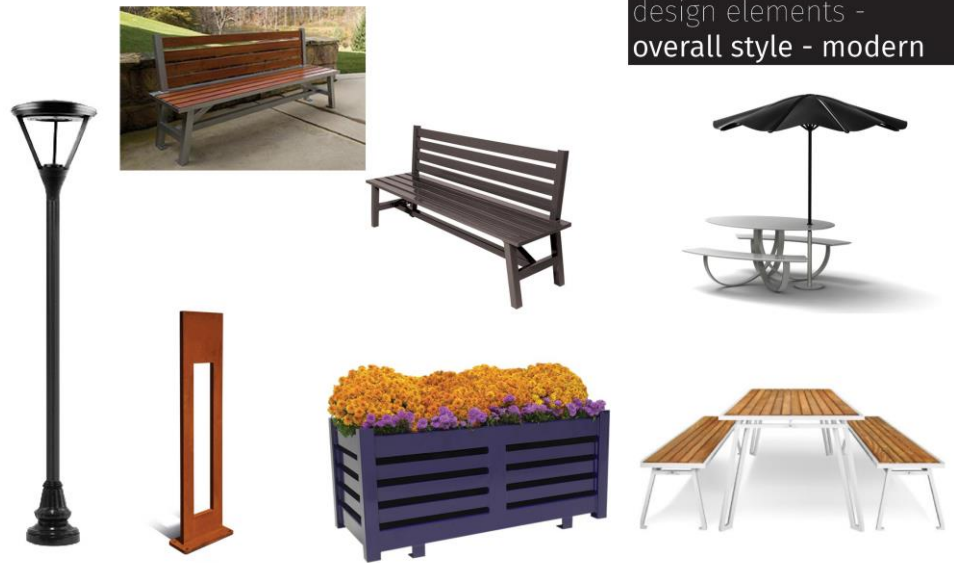

design elements -  
overall style - artistic



# 21<sup>st</sup> CENTURY STREET

A 21<sup>st</sup> Century Street should incorporate the following considerations:

- Smart street details
- Green / sustainable details
- Complete Street details
- Universal accessibility details
- Vision Zero details
- Neighborhood priorities
- Equitable design details



# BIG IDEA

CREATE AN ARTS AND CULTURAL DISTRICT – “BLACK AVENUE” – THAT EMPHASIZES BLACK-OWNED BUSINESSES, CONNECTS NEIGHBORHOODS AND PROVIDES A PLACE FOR SELF-EXPRESSION, COLOR AND ART.



# BIG IDEA

CREATE A SERIES OF FLEXIBLE PARKS, PLAZAS AND WELCOMING PUBLIC SPACES WHERE THE COMMUNITY CAN GET TOGETHER.



# Project Approach

“Create a national model public space that emphasizes seamless connectivity and accessibility - promoting physical, social, and technological links – with an underlying commitment to justice and equity.”



# What does Black Avenue mean to you?





# What do you think? Let's have a conversation.

WE WILL BE MOVING INTO SMALLER  
VIRTUAL CHAT ROOMS

YOU WILL RECEIVE A NOTICE THAT YOU  
ARE BEING PLACED IN A BREAKOUT ROOM  
– PLEASE CLICK THE BUTTON TO ENTER

EACH ROOM WILL HAVE SOME  
FACILITATORS TO HELP GUIDE THE  
DISCUSSION

WE WILL PROVIDE A COUNTDOWN WHEN  
IT'S TIME TO GO BACK TO THE MAIN  
DISCUSSION, AND YOU WILL BE RETURNED  
TO THE MAIN GROUP AUTOMATICALLY

# Share out - What does Black Avenue mean to you?



SWEET AUBURN HISTORIC DISTRICT, ATLANTA



BLACK WALL STREET, TULSA



BRONZVILLE, CHICAGO



BLACK WALL STREET, TULSA



BRONZVILLE, CHICAGO



SIX SQUARE, AUSTIN



# NEXT STEPS & CHECK- OUT

